

**So Fast,
So Simple...**

So Gecko

the facade mounting system reinvented !



www.gecko-fix.com





The Gecko[®] brackets

the facade mounting system reinvented!

This patented system was designed to create a simple and faster alignment for a supporting structure for any type of cladding that is installed floating with or without insulation.

Advantages:

- ▷ No thermal bridges
- ▷ Easy / simple placement
- ▷ Fast alignment = up to 40% faster assembly time
- ▷ Made from 100% recycled material
- ▷ Standard mounting bolts
- ▷ Alignment can be done with screws as well as with gas/pressure air nailing machine
- ▷ No special tools required
- ▷ 3 brackets for all applications !
 - ▷ BG210 = mineral wool applications (vertical twill structure)
 - ▷ BG110 = PUR applications (vertical twill structure)
 - ▷ BG90-H = PUR applications (horizontal and/or angled* twill structure)
- ▷ Extra large margin for alignment up to even 90mm
- ▷ Ideal for renovation applications
- ▷ Can be placed and aligned by 1 person

**placed up to a 30° angle, subject to installation guidelines.*

Gecko[®] BG210



BG210

The Gecko[®] BG210 is ideal for mineral wool applications due to its long range. The Gecko[®] BG210 is mounted directly to the wall or construction behind it.

Because the holes are foreseen at 200mm, the fixings (with traditional quick construction) can always be screwed nicely into the mortar joint. Because the insulation comes in and around the bracket, there is no risk of thermal bridges anymore. The Gecko[®] BG210 has an insulation capacity of 120mm up to 210 mm and provides a 90mm alignment capacity.

1

Measure the dimensions on the wall

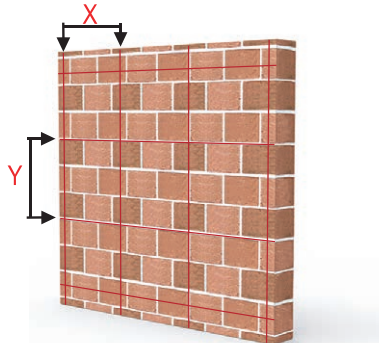

2

Drill the holes

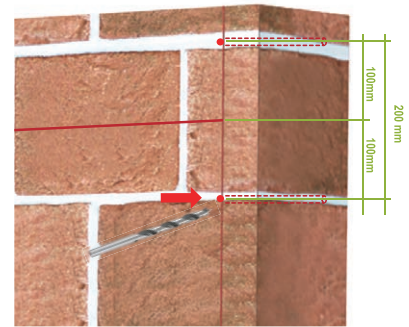

3

Mount the bracket with screws & plugs

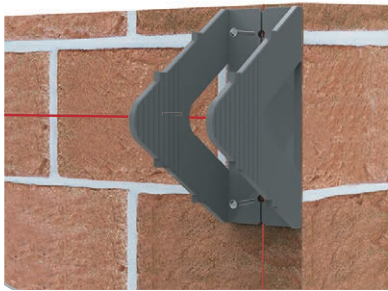

4

Place the glass wool insulation

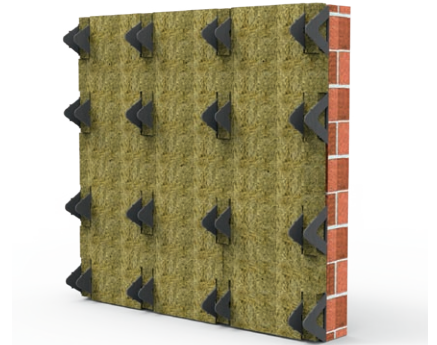

5

Fix the support boards with screws or nail gun

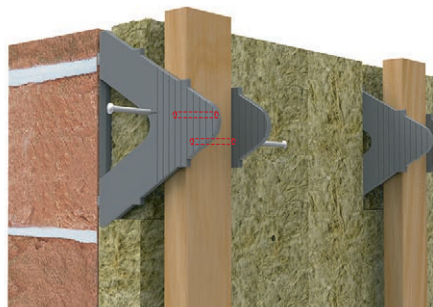

6

Ready to cut off the protruding parts of the bracket

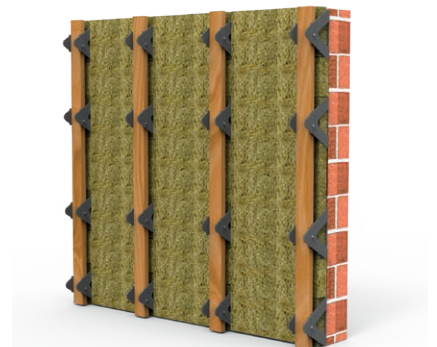

7

Saw off at the desired height

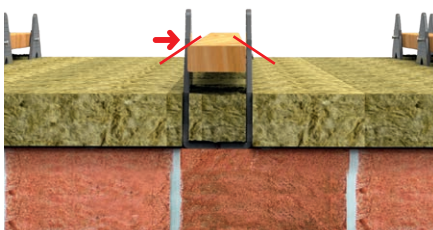

8

Ready for the cladding



Gecko[®] BG110

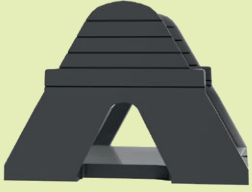

BG110

The Gecko[®] BG90-H and BG110 have been developed for the hard PIR/PUR insulation materials. These brackets are screwed against the insulation whereby the upper facade frame plug is drilled at an angle of 30° and the lower one horizontally into the rearward support wall/construction. They can be used for both insulated and non-insulated facades.

The Gecko[®] BG110 is the little brother of the BG210. It has a total alignment capacity of 19 to 82mm so that it can compensate for any unevenness in the facade. By lifting the Gecko[®] BG110 with the bottom corner attachment it is ideal for insulated applications and the holes must be drilled at 120 mm heart to heart. In the case of renovation without insulation, turn the bracket 180° so that it can be fixed with the holes drilled at 60mm heart to heart.

1

Place the PUR insulation directly against the wall and measure the dimensions on the insulation.

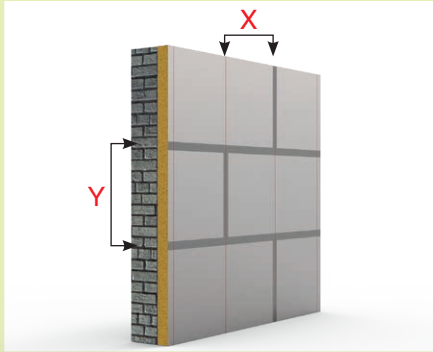

2

Drill the holes

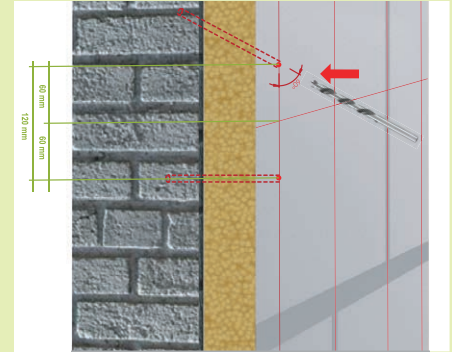

3

Mount the bracket with the screws



4

Place the rest of the brackets



5

Fix the support boards with screws or nail gun

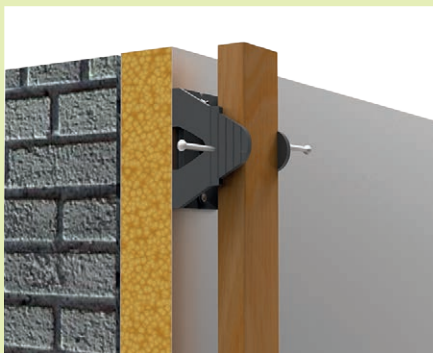

6

Ready to cut off the protruding parts of the bracket



7

Saw at an angle at the desired height

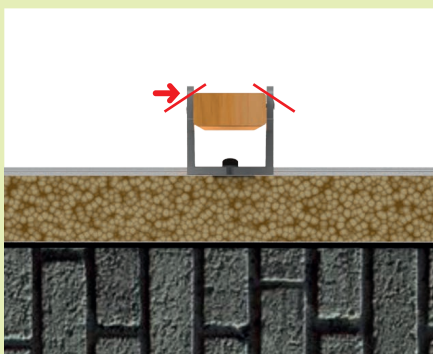

8

Ready for the cladding



Gecko[®] BG90-H

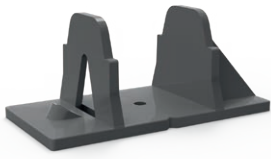

BG90-H

The Gecko[®] BG90-H is a bracket designed to directly align a horizontal slightly slanted supporting structure without having to provide for double twill work so that a faster assembly can be achieved. This Gecko[®] BG90-H has an alignment capacity from 9 to 62mm. By lifting the Gecko[®] BG90-H with the bottom corner attachment it is ideal for insulated applications and holes must be drilled at 160mm heart to heart. In case of renovation without insulation, holes are drilled at 80mm or 160mm heart to heart.

1

Place the PUR insulation directly against the wall and measure the dimensions on the insulation.

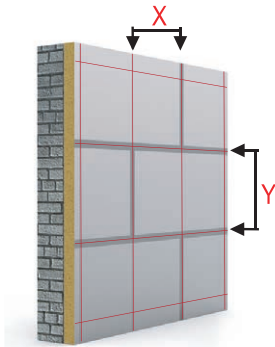

2

Drill the holes

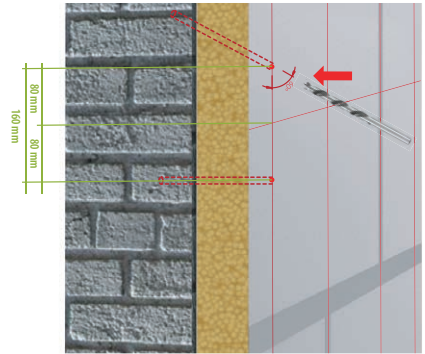

3

Mount the bracket with screws & plugs

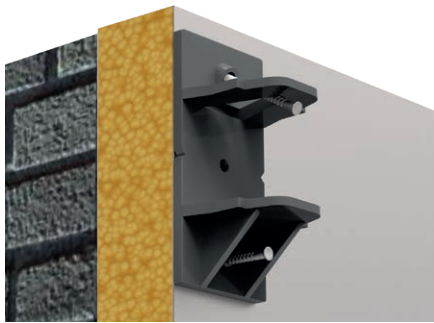

4

Place the rest of the brackets



5

Fix the support boards with screws or nail gun



6

Ready to cut off the protruding parts of the bracket



7

Saw at an angle at the desired height

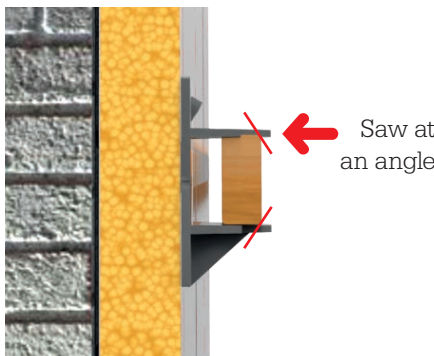

8

Ready for the cladding



Mounting and partitioning of the brackets

		Distances X (mm)																	
		300			350			400			450			500			600		
pc/m ²	kg/m ²	A	B	C	A	B	C	A	B	C	A	B	C	A	B	C	A	B	C
Distances Y (mm)	400	8,3			7,1			6,3			5,6			5,0			4,2		
		208,3	145,8	102,1	178,6	125,0	87,5	156,3	109,4	76,6	138,9	97,2	68,1	125,0	87,5	61,3	104,2	72,9	51,0
	500	6,7			5,7			5,0			4,4			4,0			3,3		
		166,7	116,7	81,7	142,9	100,0	70,0	125,0	87,5	61,3	111,1	77,8	54,4	100,0	70,0	49,0	83,3	58,3	40,8
	600	5,6			4,8			4,2			3,7			3,3			2,8		
		138,9	97,2	68,1	119,0	83,3	58,3	104,2	72,9	51,0	92,6	64,8	45,4	83,3	58,3	40,8	69,4	48,6	34,0
	800	4,2			3,5			3,1			2,8			2,5			2,1		
		104,2	72,9	51,0	89,3	62,5	43,8	78,1	54,7	38,3	69,4	48,6	34,0	62,5	43,8	30,6	52,1	36,5	25,5

- A:** direct mounting on the wall
- B:** with 6 cm insulation BG110 & BG90-H
- C:** with 12 cm insulation BG110 & BG90-H

This table is purely informative. It is the installer's own responsibility to check whether the desired covering meets the predefined parameters.

Consult your Gecko® dealer or specialist.

Your Gecko® specialist



Gecko® has been active in the construction sector since 2008.

This mainly in support of contractors with facade cladding, roofing and general structural work.

By continuously sharing its knowledge with architects, engineers and contractors, Gecko® wants to play a role in the development of materials that are installed qualitatively, efficiently and productively so that a higher return is achieved for the contractors without, however, compromising the quality and durability.

www.gecko-fix.com

Gecko® BV | Hollestraat 17, 3290 Deurne
info@gecko-fix.com

